

Know Your Oscilloscope

Getting Started

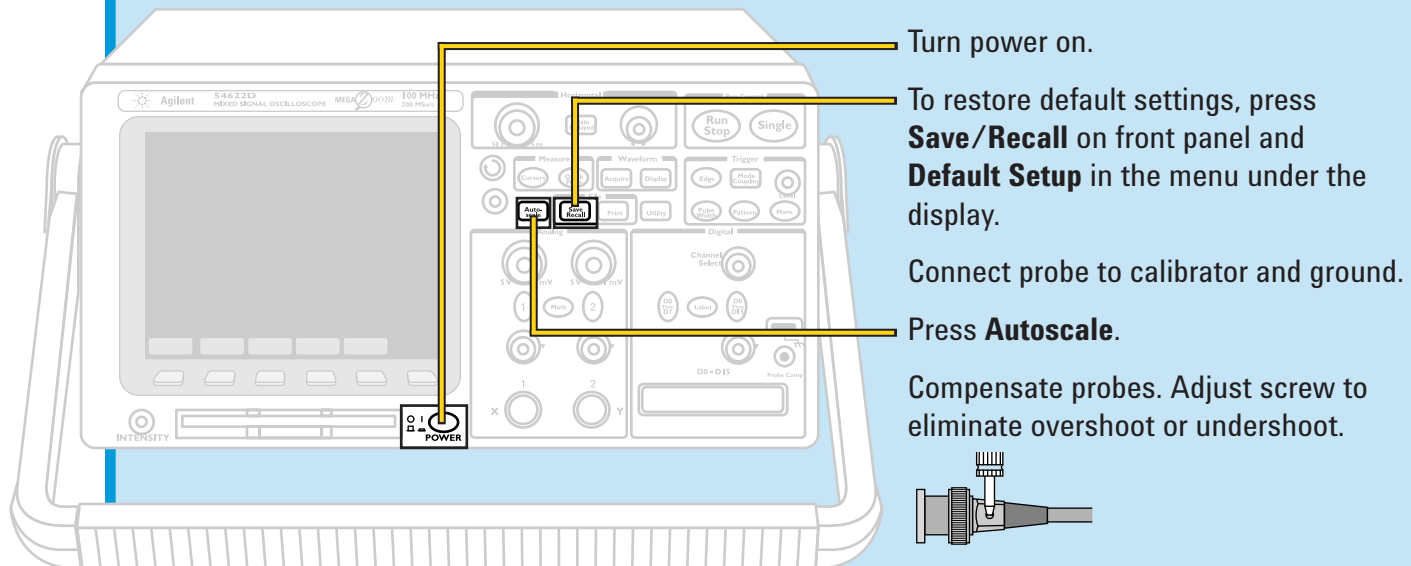

- Turn power on.
- To restore default settings, press **Save/Recall** on front panel and **Default Setup** in the menu under the display.
- Connect probe to calibrator and ground.
- Press **Autoscale**.
- Compensate probes. Adjust screw to eliminate overshoot or undershoot.

Built-in Help

- Read the Help display when you turn the scope on for helpful hints.
- Press and hold any key to view built-in quick help in choice of 11 languages.
- For example, press and hold **Pattern** key to view explanation of pattern trigger mode.

Controls

Horizontal - Time Controls

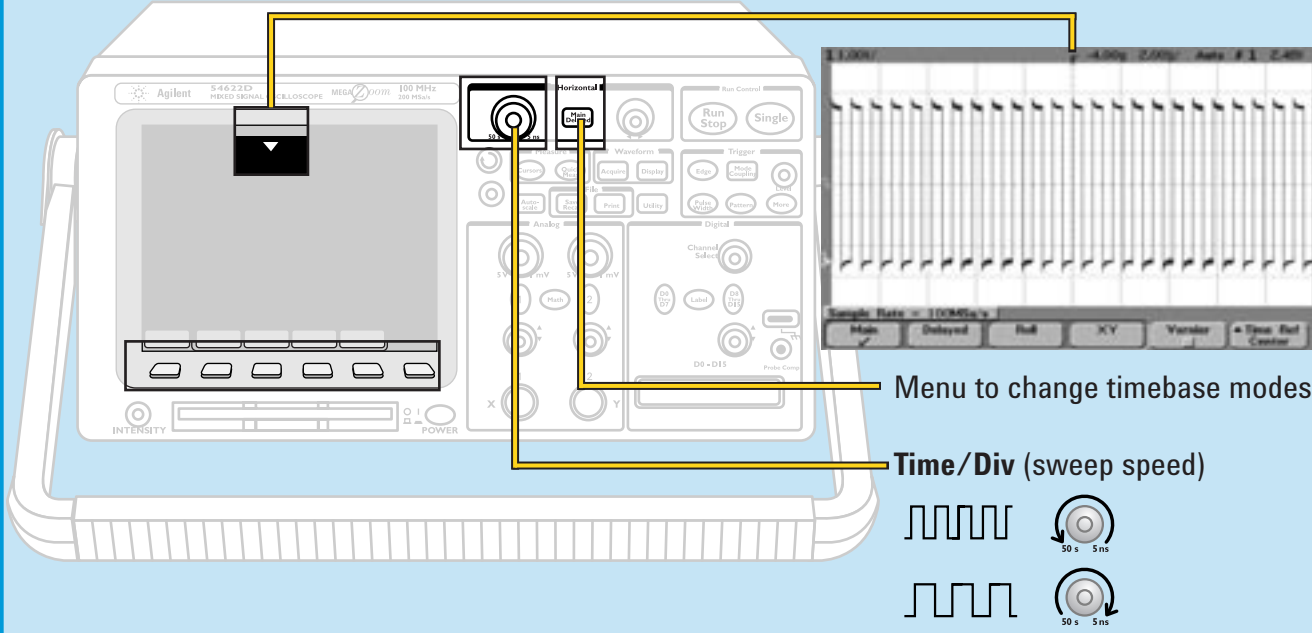

Menu to change timebase modes

Time/Div (sweep speed)



What the display says:

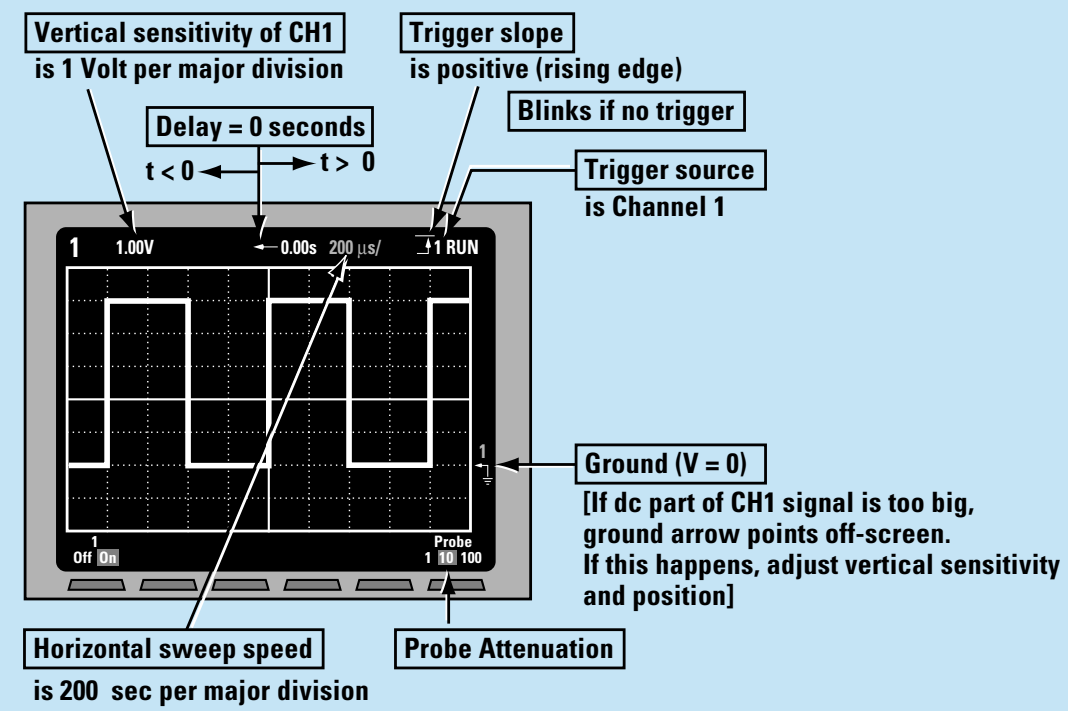

Voltage Controls

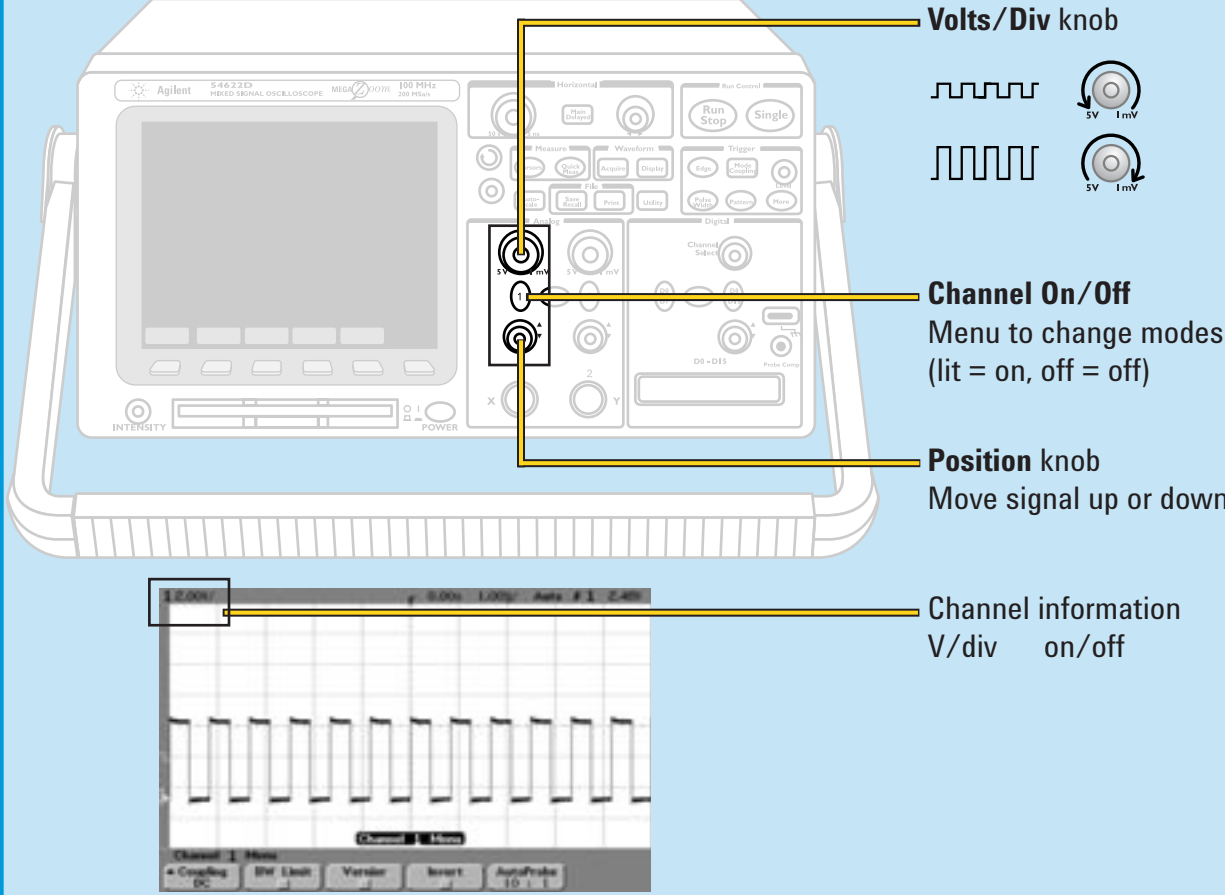

Trigger Controls

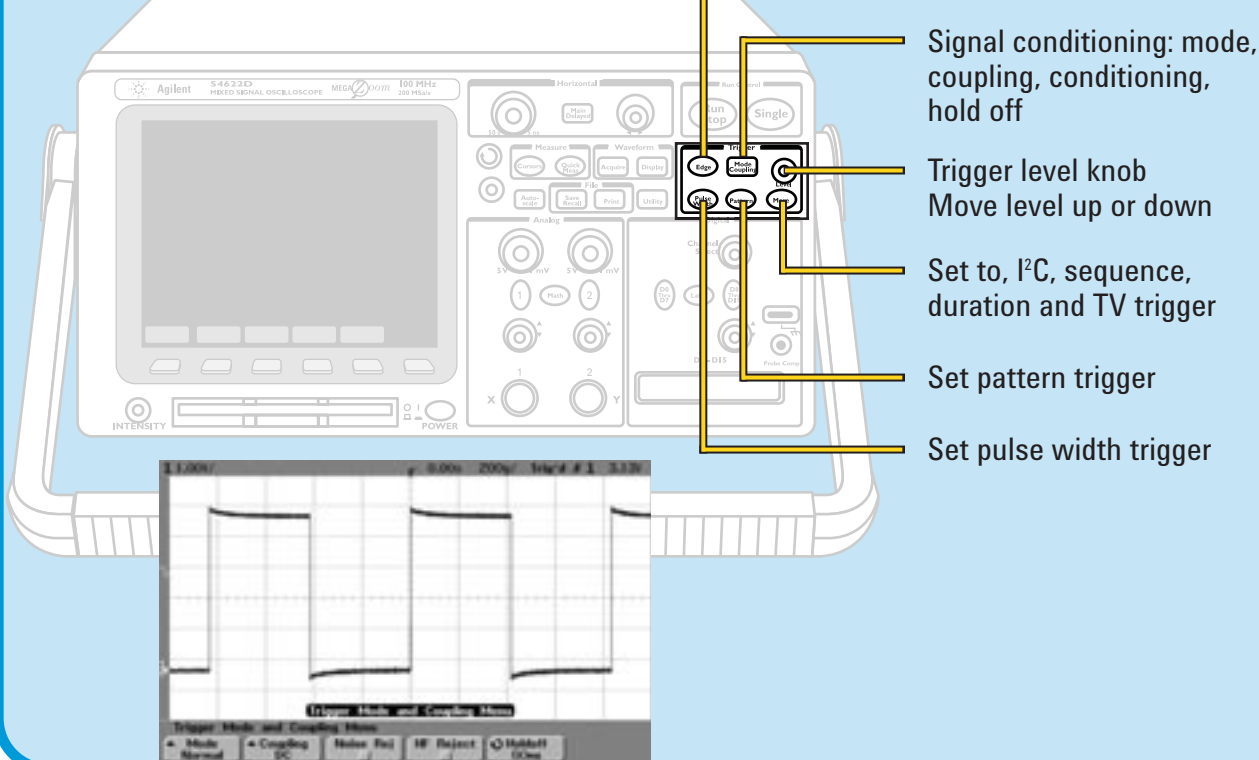

Sharing Agilent's Resources with Engineering Educators

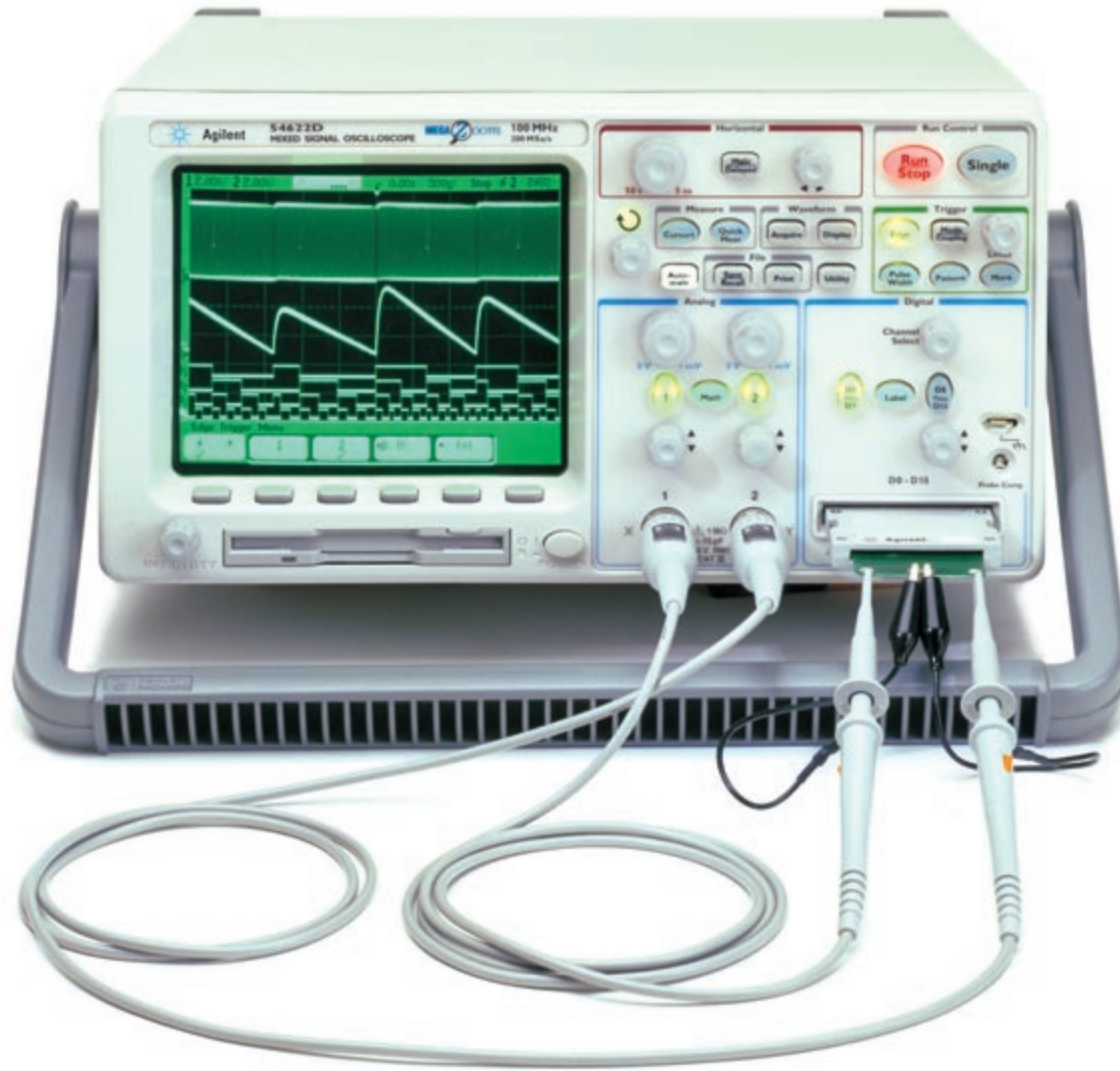

Overview

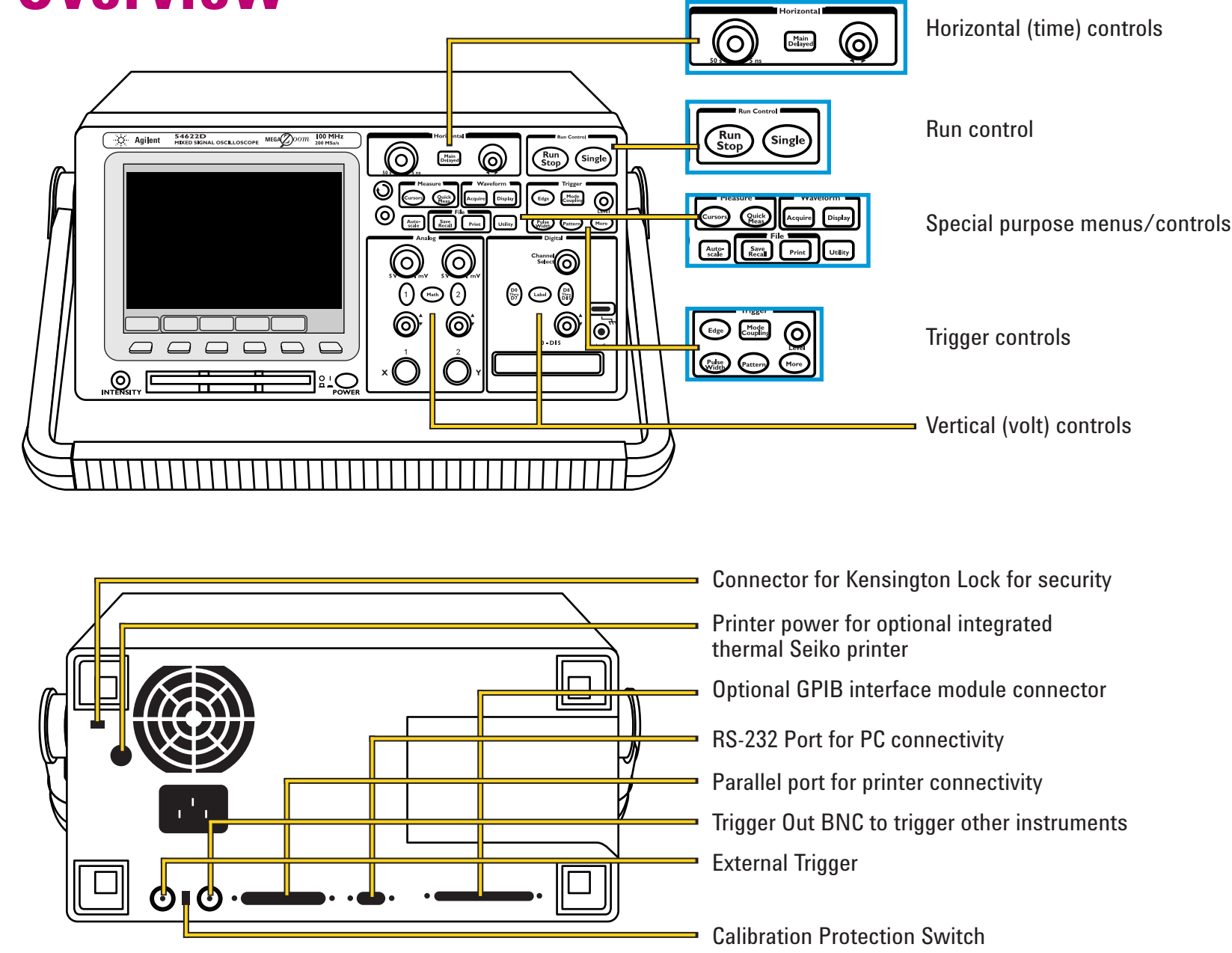

Hints

- The Digitizing Oscilloscope
- The BNC shield is at earth ground. Use only the probe TIP for measuring high voltages. "Floating" the BNC shield or connecting it to a high voltage could cause a safety hazard.
 - Make sure probes are compensated.
 - If you can't get the signal on screen:
 - Check probe connection
 - Touch: **SETUP**, Default Setup
 - Touch: **AUTOSCALE**
 - Check for offset (ground symbol). If offscale, adjust vertical sensitivity and position
 - Turn up signal brightness with intensity control

Digital Oscilloscope Block Diagram

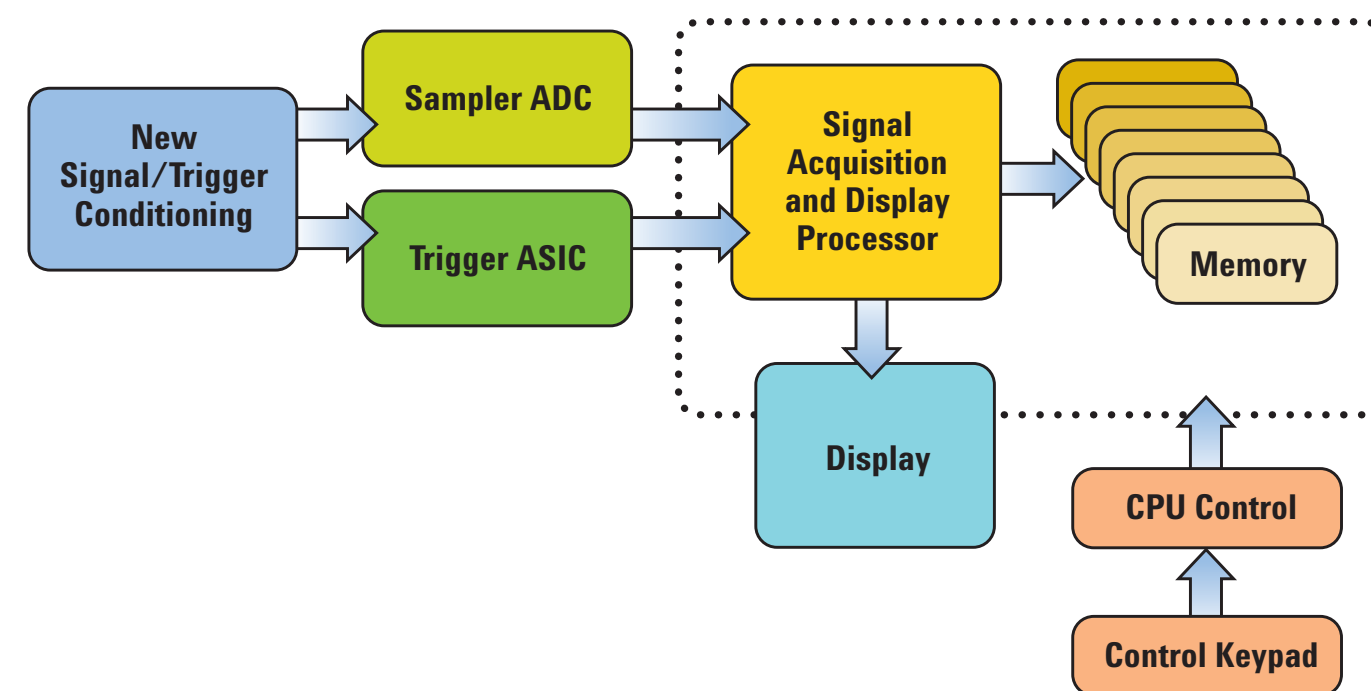

Display

MegaZoom - the deep memory advantage

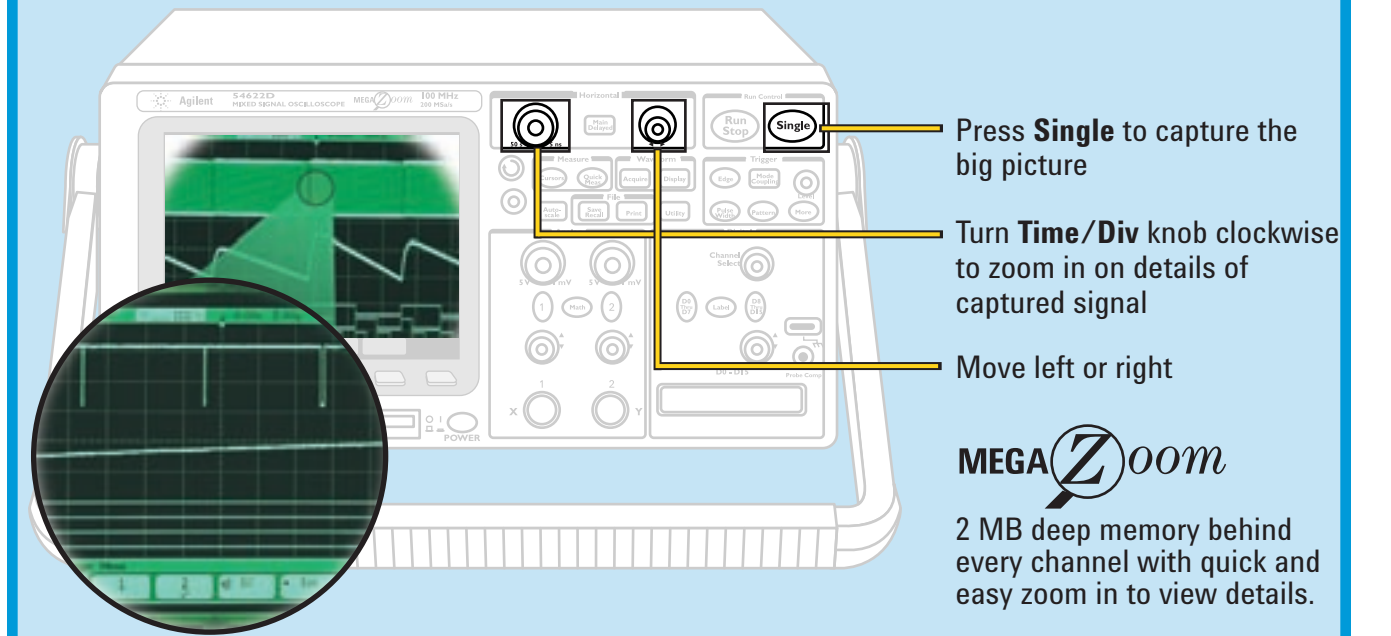

High definition Display

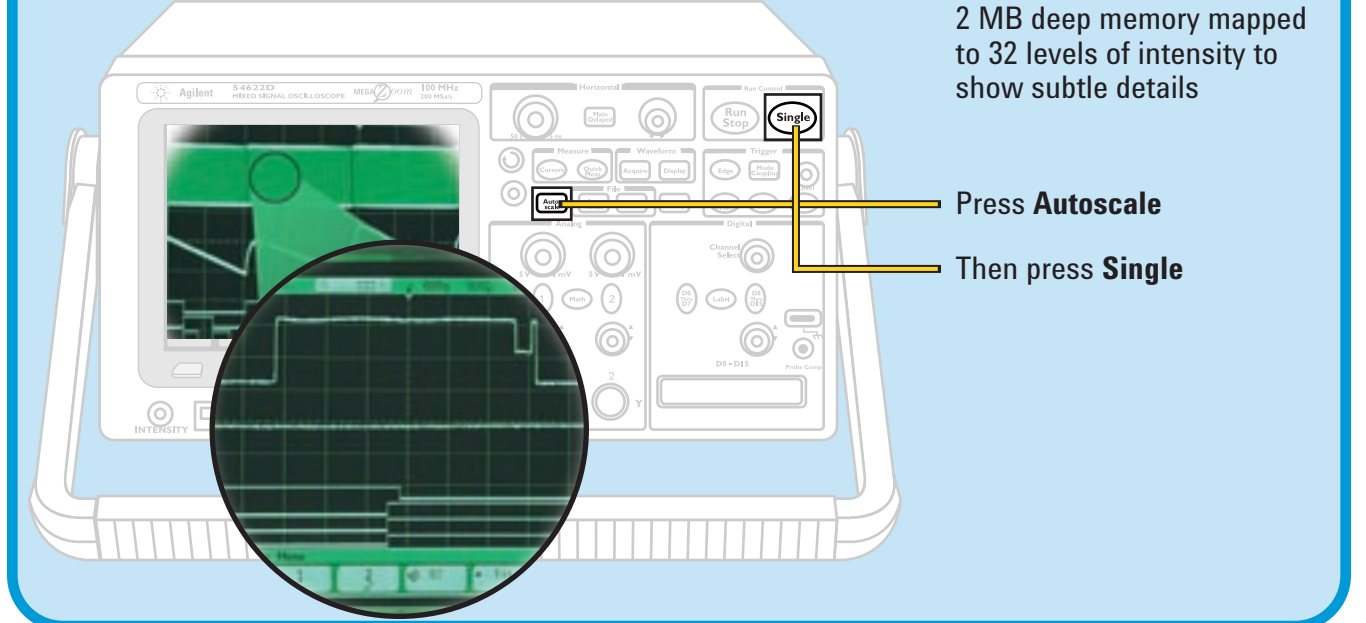

Other Functions

Making Automatic Measurements (Vpp, frequency, etc.)

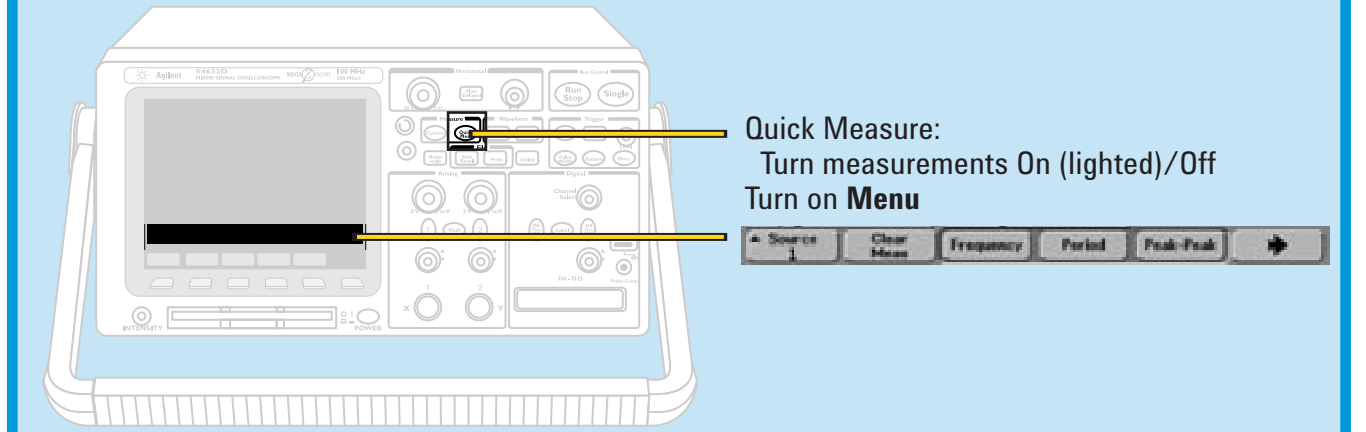

Manual Marker Control

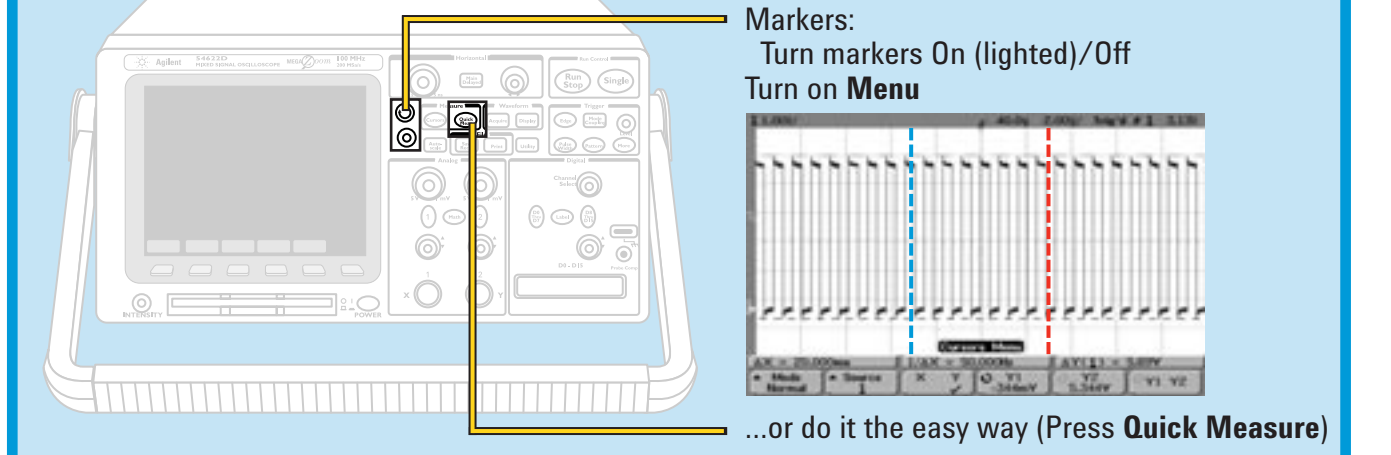

Saving Information

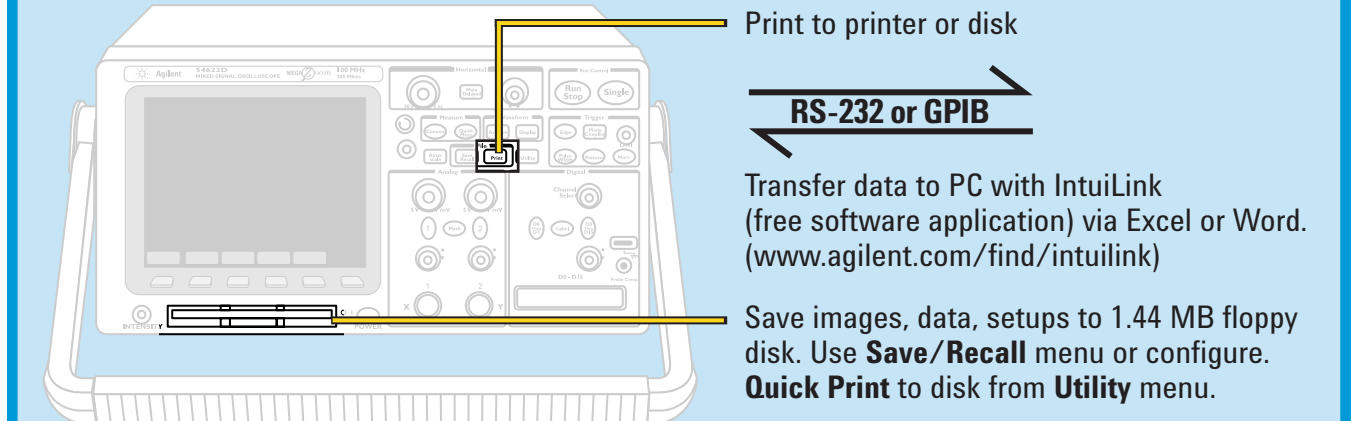

Math Functions (*, -, FFT, etc.)

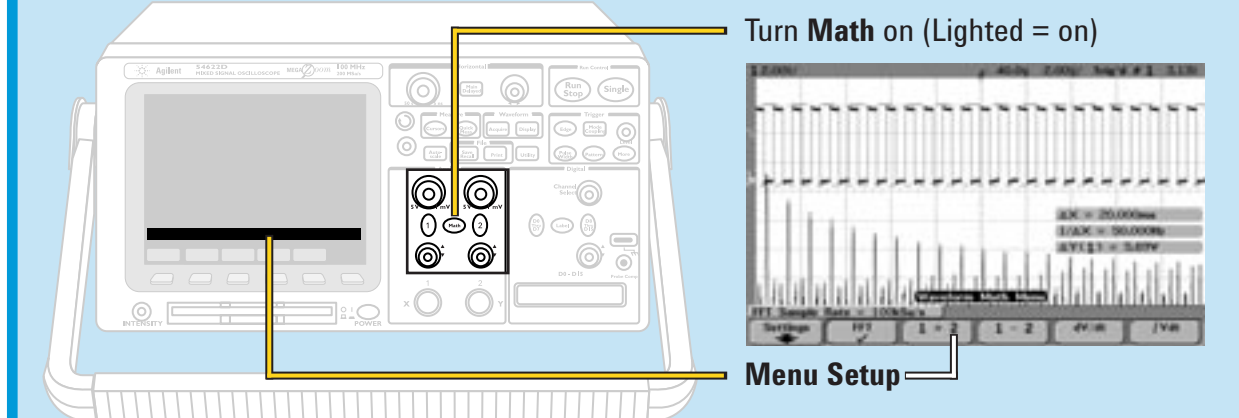

Channel Configurations

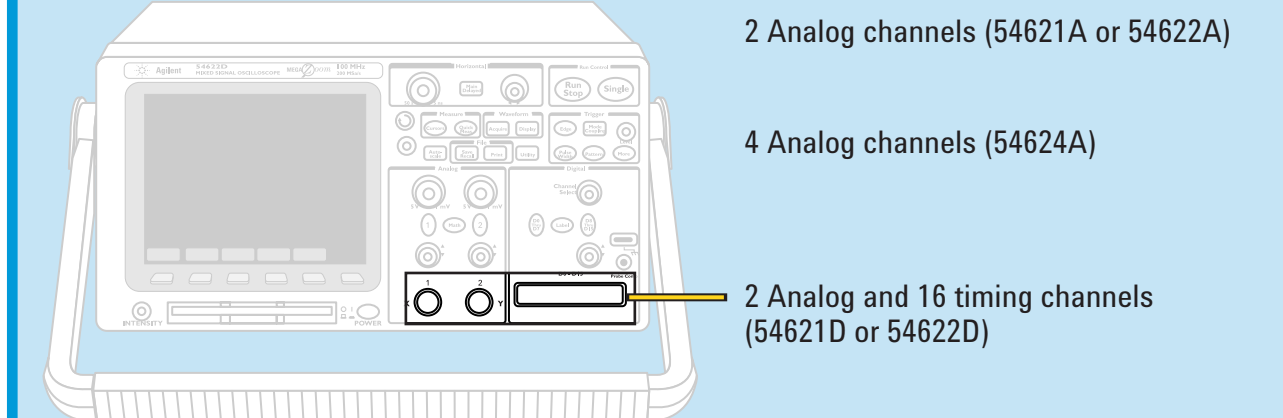

Menus - Advanced Controls

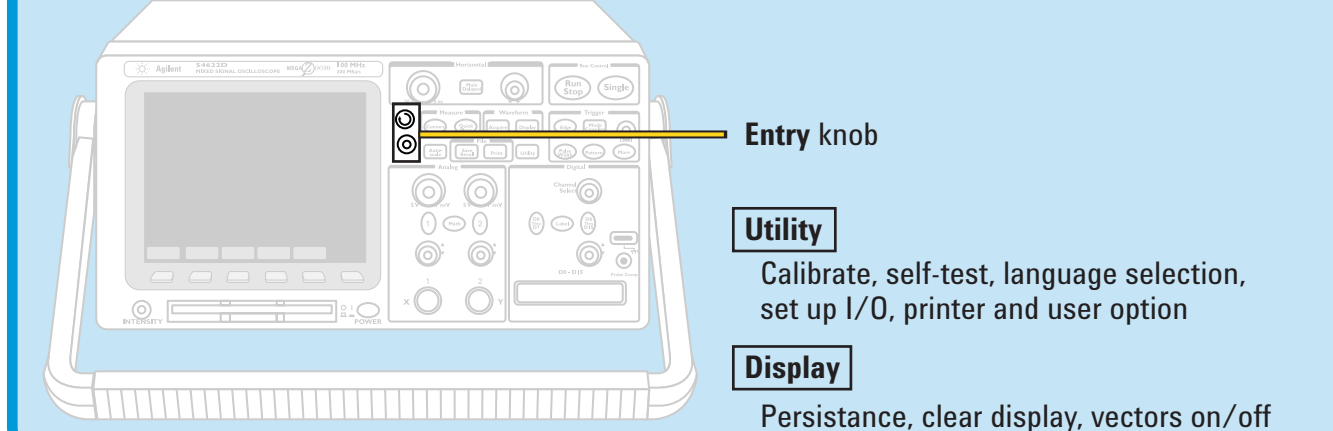

www.EducatorsCorner.com